

**ITEM 14. MOBILE CRANES – TEMPORARY ROAD CLOSURES – GOODLET
STREET SURRY HILLS**

TRIM RECORD NO: 2016/571110

RECOMMENDATION

It is recommended that the Committee endorse the temporary road closure of Goodlet Street, between Riley and Marlborough Streets, Surry Hills, on Saturday 21 January 2017 from 7am to 5pm, subject to the following conditions:

- (A) The Applicant must comply with the temporary road closure conditions as mentioned in Schedule C of this Agenda.
- (B) The Applicant must comply with any other conditions imposed by City's Construction Regulation Unit.
- (C) The Applicant has indicated the Saturday 28 January 2017 as an alternative date for the above work as a contingency for inclement weather.
- (D) The Applicant must contact the Surry Hills Police to obtain a separate police permit and to discuss deployment of user pay police for the road closure.
- (E) The Applicant must provide a telephone number of the supervisor responsible for the proposed closure and include contact details in the notification letters to be distributed to affected stakeholders.

VOTING MEMBERS FOR THIS ITEM

<i>Voting Members</i>	<i>Support</i>	<i>Object</i>
City of Sydney		
Roads and Maritime Services		
NSW Police – Surry Hills LAC		
Representative for the Member for Newtown		

DECISION

BACKGROUND

The Traffic Marshal has applied for the temporary road closure of Goodlet Street, between Riley and Marlborough Streets, Surry Hills, on Saturday 21 January 2017 from 7am to 5pm.

COMMENTS

The proposed temporary road closure is required to allow a mobile crane to lift communication equipment at 61 Marlborough Street, Surry Hills.

The Applicant has provided a site-specific Traffic Control Plan that includes details of barricades, signs, flagmen and other traffic devices to implement the proposed road closure.

There are currently no other approved temporary road closures proposed to take place on the same day in close proximity of this closure.

The temporary road closure will not affect any other properties, as local access will be provided at all times and alternative access routes are available nearby.

A Traffic Management Plan (TMP) for the temporary road closure was approved by Roads and Maritime Services (RMS) on 14 December 2016.

CONSULTATION

The Applicant will be required to notify affected stakeholders as stipulated in Schedule C.

FINANCIAL

All costs associated with the proposed closure will be borne by the Applicant.

ATTACHMENTS

Mobile Cranes – Temporary Road Closures – Goodlet Street Surry Hills

Ajay Nayyar, Traffic Works Coordinator

NOTES:

1. SPEED LIMIT 60KPH
2. CONTAINMENT FENCE ERRECTED AROUND WORKSITE.
3. DELINEATION CONES PROVIDING 1.2m BUFFER ZONE

www.invarion.com

Lansdown Street

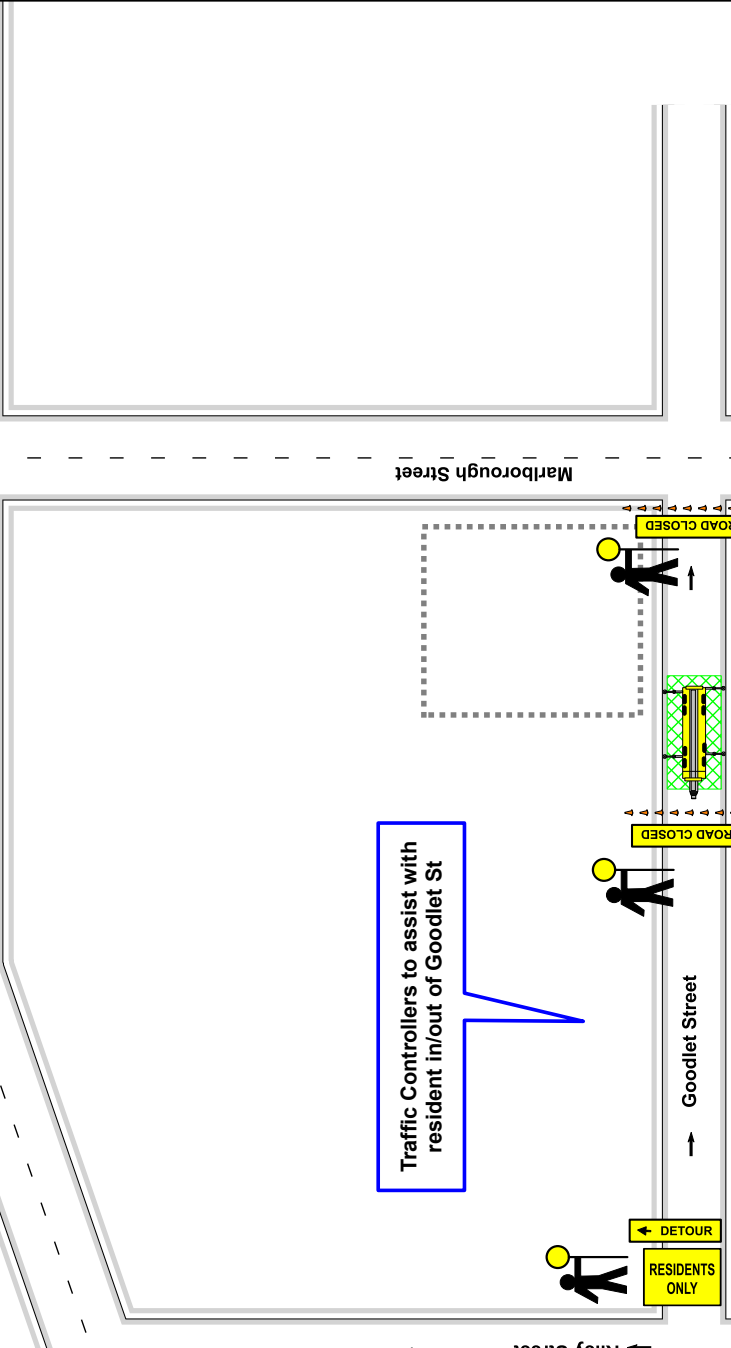

CONE SPACING

PURPOSE/USAGE	APPROACH SPEED KPH	SPACING
CENTRELINE ON APPROACH TO A TRAFFIC CONTROLLER POSITION	450	4
OUTER EDGE OF TRAFFIC LANE IE WORKS ON SHOULDER OR PARKING LANE	All cases	4
SEPARATING OPPOSING TRAFFIC ON 2 LANE-2 WAY ROAD	51-70 > 70	18 24
SEPARATING OPPOSING TRAFFIC ON A MULTILANE UNDIVIDED ROAD AS PART OF A LANE CLOSURE	51-70 > 70	12 18
ADJACENT TO A CLOSED LANE ON A MULTILANE UNDIVIDED RD	51-70 > 70	18 24
MERGE TAPERS	51-70 > 70	9 12
LATERAL SHIFT TAPERS	51-70 > 70	12 18

RECOMMENDED TAPER LENGTH, m			
APPROX SPEED TRAFFIC KPH	CONTROLLER TAPER START	LATERAL SHIFT TAPER	MERGE TAPER
45 or Less	15	0	15
46-55	15	15	30
56-65	30	30	60
66-75	N/A	N/A	115
76-85	80	80	130
86-95	N/A	90	145
96-105	N/A	100	160

AMENDED BY	
CERT #	
TIME	
DATE	

Date: 28/10/2016 **Author:** Bridget Diggins **Project:** Goodlet Street, Surry Hills

Comments:
 Drawn: Bridget Diggins
 Orange Ticket No-0026675150
 Goodlet Street, Surry Hills - Detour East

DRAWING NOT TO SCALE
 IF THIS TCP IS IMPLEMENTED BY A TRAFFIC CONTROL COMPANY OTHER THAN TTM,
 TTM BEARS NO LIABILITY FOR THE SET UP AND ACCURACY OF THIS TCP.

